

**service**

**hp** LaserJet  
4200/4250/4300/4350  
series printers

## Transfer roller

- 1 Open the control-panel door and tray 1.

 **CAUTION** Do not touch the black rubber on the roller. Skin oils on the roller can cause print-quality problems. The use of disposable gloves is recommended when you remove the transfer roller.

- 2 Use a transfer-roller removal hook (callout 1) to lift the left end of the metal shaft out of place near the blue gear (callout 2). If a removal hook is not available use a flat-blade screwdriver. Slide the transfer roller to the left to remove it.

 **CAUTION** Be careful to release and lift the left side of the roller *first*, and then slide the roller out.

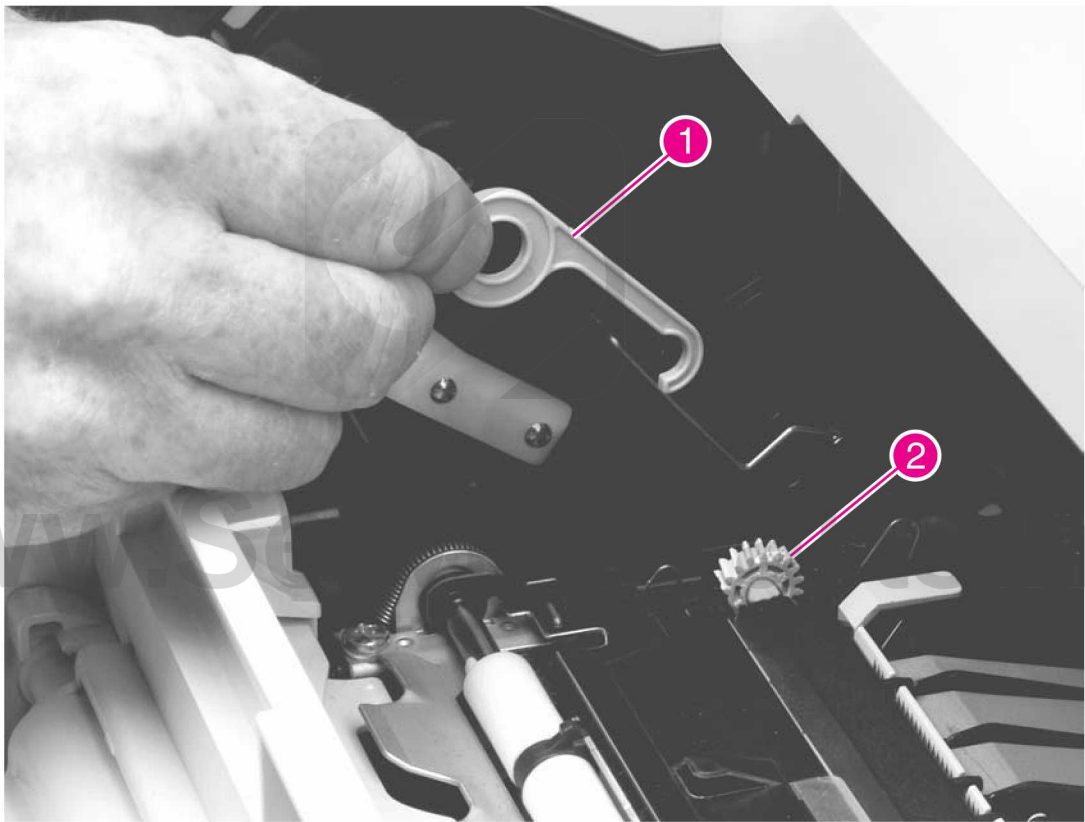

**Figure 6-5** Transfer roller

 **Reinstallation tip** When you install the transfer roller, make sure that the black collar on the left side is oriented correctly, with the open end face-down (the solid end is face-up).